

## TECHNICAL DATA | EF END CAP

Standards: AS/NZS 4129 | SDR11 | SDR17

Size Range: 20 mm - 250 mm

Materials: Polyethylene (PE) 100

Pressure Rating: PN16, Water | PN10, Gas

- Fitting Details:
- Injected
  - 4mm automatic pin



size mm	L10 mm	L1 mm	D mm	D1 mm	Weight kg	SDR	Code
20	82	37.5	29	30	0.045	11	EFCAP20
25	82	27.5	33.5	25	0.052	11	EFCAP25
32	84	37.5	43	32	0.08	11	EFCAP32
40	97	44	51.5	40	0.118	11	EFCAP40
50	101	44	61.5	50	0.138	11	EFCAP50
63	115	50	78	63	0.248	11 - 17.6	EFCAP63
75	133	59.5	92.5	75	0.384	11 - 17.6	EFCAP75
90	138	60	109.5	90	0.545	11 - 17.6	EFCAP90
110	164	70	133	110	1.885	11 - 17.6	EFCAP110
125	175	75	151	125	1.224	11 - 17.6	EFCAP125
140	236	89	176	140	1.845	11 - 17.6	EFCAP140
160	202	86	195	160	2.242	11 - 17.6	EFCAP160
180	214	92	219	180	3.126	11 - 17.6	EFCAP180
200	215	92	242	200	3.853	11 - 17.6	EFCAP200
225	251.7	111	270	225	6	11 - 17.6	EFCAP225
250	259.5	111	303	250	7.73	11 - 21	EFCAP250

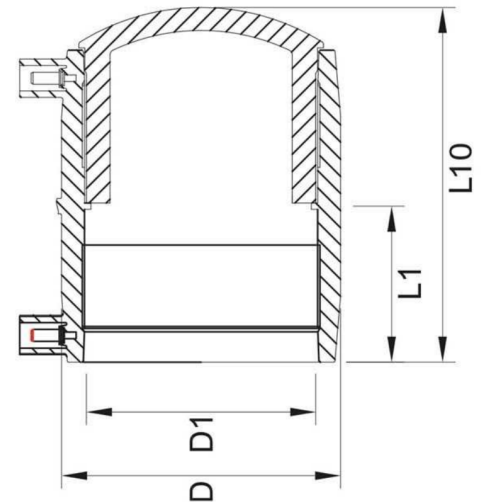

**Note:**

Installation should always be performed by a licensed operator. It is the responsibility of the installer to check that both the pipe(s) and fitting(s) that are installed are compatible, only compatible materials should be joined together. It is the responsibility of the licensed installer to check the PN and SDR ratings marked on the fitting(s) and ensure that the pipe is compatible. Correct installation procedures should always be followed.

The drawings, materials and specifications outlined are subject to change without notice due to the continuous improvements and development of our product range.

**FUSION QLD PTY LTD**

ABN: 42 987 067 369  
13 Vision Court, Noosaville, QLD, 4566  
42-44 South Link, Dandenong, VIC, 3175

**CONTACT**

T: +61 7 5474 3000 (Qld)  
T: +61 3 9037 4755 (Vic)  
E: sales@fusionqld.com.au  
W: fusionqld.com.au